

# Adapter Flange for butterfly flange AF 40 to AF 125

The *asa* suction unit is screwed to the *asa* adapter flange, which is welded to the tank. Due to low installation costs and compact design, purchasing *asa* suction units is cost effective. A switch (mechanical or inductive) can be mounted on the standard block for monitoring matters. The adapter flange may only be welded with demounted butterfly flange.

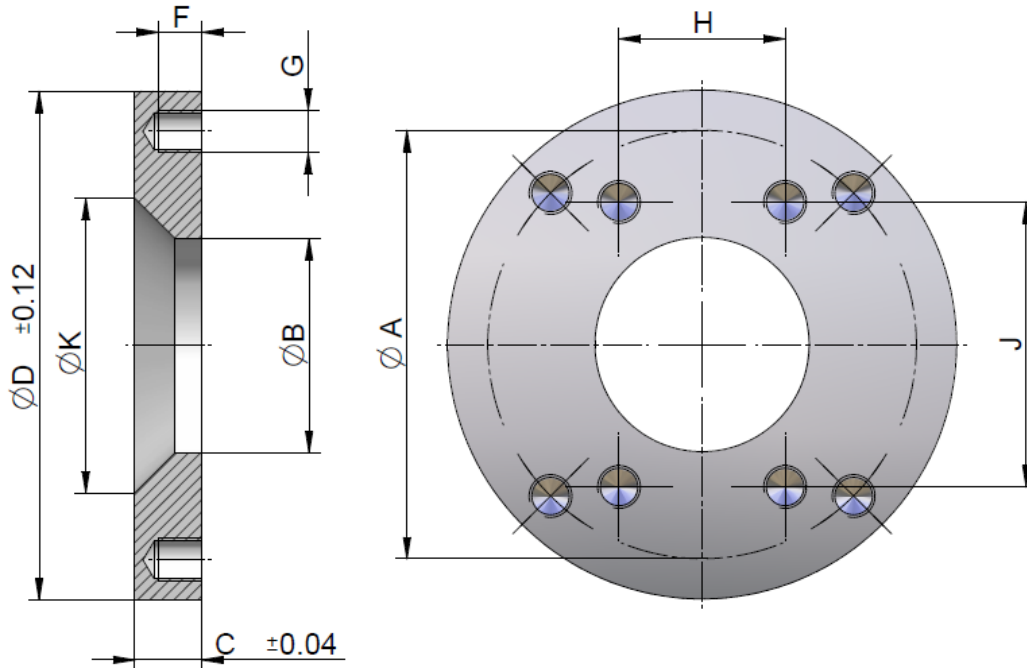

## Technical Data

| order number | description     | A    | B    | C    | D    | F    | G        | H    | J    | K           | weight |
|--------------|-----------------|------|------|------|------|------|----------|------|------|-------------|--------|
|              |                 | [in] | [in] | [in] | [in] | [in] | [mm]     | [in] | [in] | [in]        | [lbs]  |
| SDAET040KU00 | adapter 40      | 4.33 | 1.93 | 0.98 | 5.12 | 0.55 | M12 (4x) | --   | --   | 3.50 ± 0.04 | 4.18   |
| SDAET063KU00 | adapter 50 & 63 | 4.92 | 2.48 | 0.98 | 5.91 | 0.63 | M12 (4x) | --   | --   | 4.06 ± 0.04 | 5.39   |
| SDAET080KU00 | adapter 80      | --   | 3.23 | 0.98 | 5.91 | 0.55 | M16 (4x) | 2.44 | 4.19 | 4.29 ± 0.04 | 4.73   |
| SDAET100KU00 | adapter 100     | --   | 4.06 | 0.98 | 7.09 | 0.55 | M16 (4x) | 3.06 | 5.12 | 5.47 ± 0.04 | 6.16   |
| SDAET125KU00 | adapter 125     | --   | 5.04 | 0.98 | 8.07 | 0.55 | M16 (4x) | 3.62 | 6.00 | 6.46 ± 0.04 | 7.26   |

## Material

|                 |                        |
|-----------------|------------------------|
| flange material | steel 1.0037 or 1.0570 |
|-----------------|------------------------|

## Material

|                    |       |
|--------------------|-------|
| delivery condition | oiled |
|--------------------|-------|

## Fits On

|              |  |
|--------------|--|
| SDAET040KU00 | SDA0040U00, SDA00040W                        |
| SDAET063KU00 | SDA0050U00, SDA0063U00, SDA00050W, SDA00063W |
| SDAET080KU00 | SDA0080U00, SDA00080W                        |
| SDAET100KU00 | SDA0100U00, SDA00100W                        |
| SDAET125KU00 | SDA0125U00, SDA00125W                        |

